

AT 8AM, FOR ALL SEASONS OF THE YEAR, THERE IS NO SHADOW EFFECT FROM THE PROPOSED DEVELOPMENT ON ADJACENT PROPERTIES.

8AM

EXISTING WABC

PROPOSED WABC/SUNRISE

MATTER OF RIGHT CHURCH

SPRING

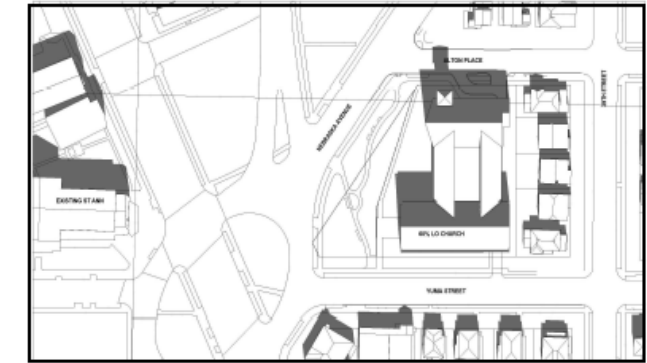
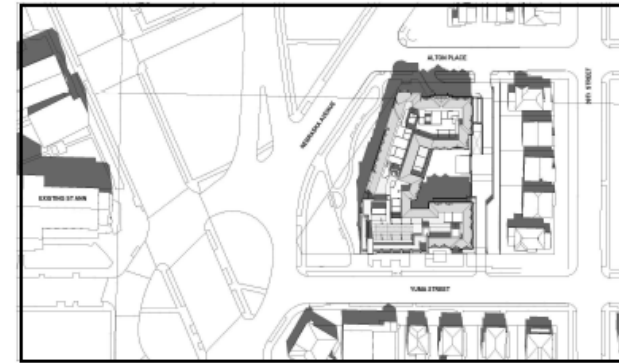
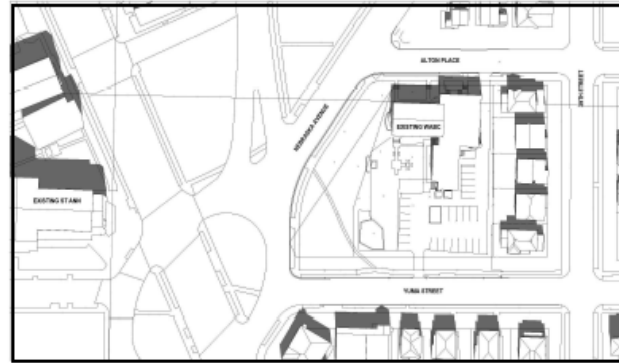

SUMMER

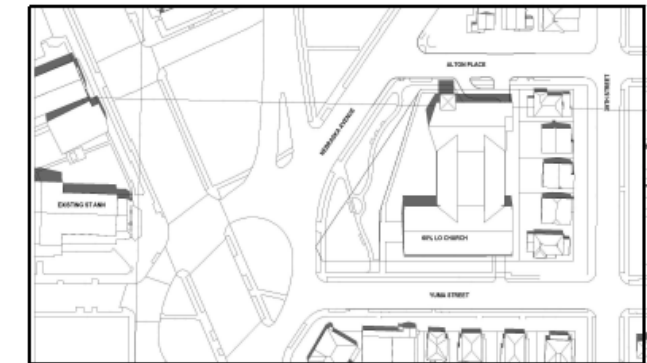

FALL

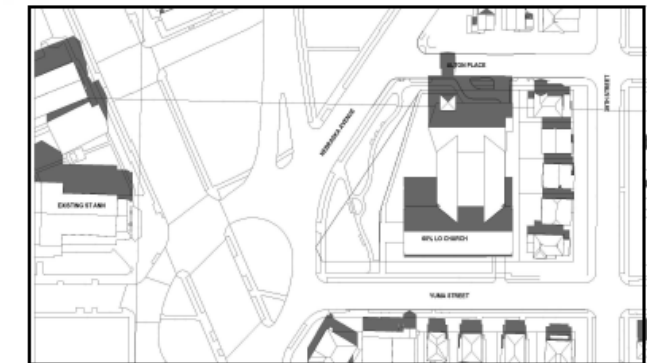
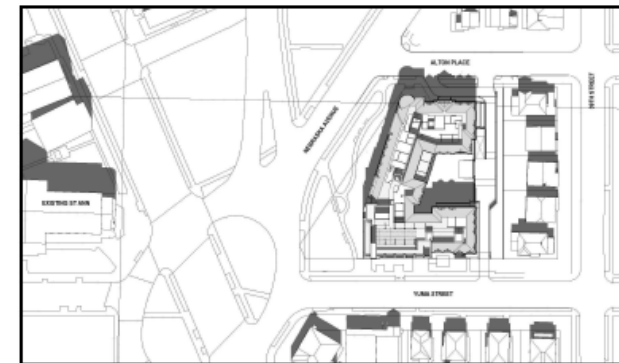
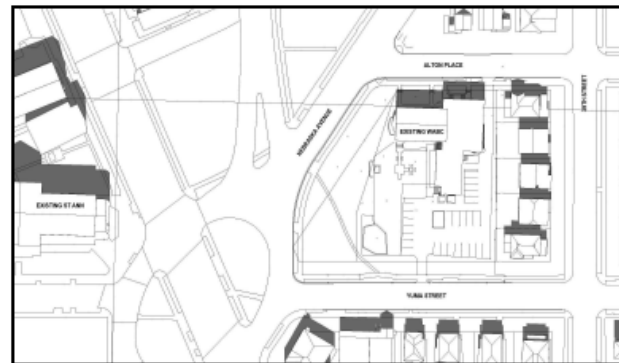

WINTER

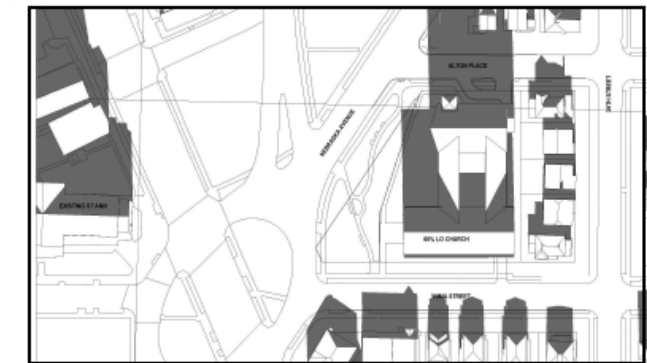
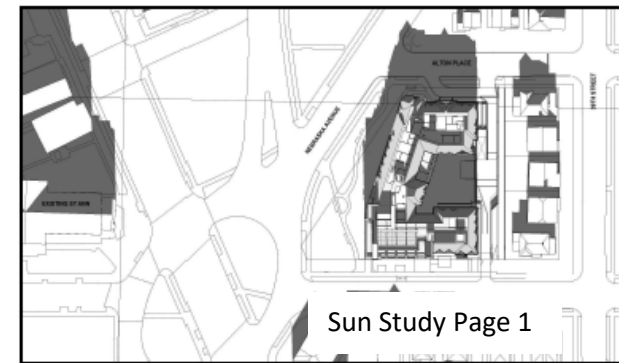
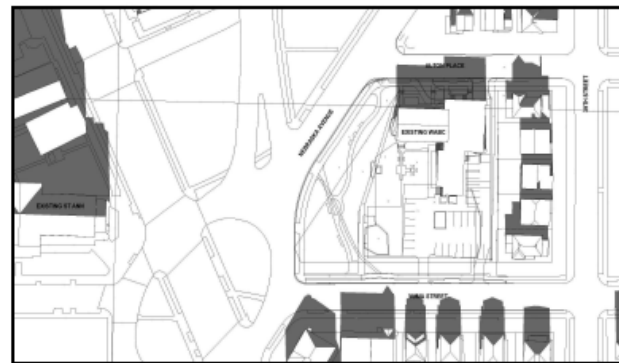

AT 12PM, FOR ALL SEASONS OF THE YEAR, THERE IS NO SHADOW EFFECT FROM THE PROPOSED DEVELOPMENT ON ADJACENT HOUSES EXCEPT FOR THE M.O.R. OPTION IN THE WINTER.

Sun Study Page 1

12PM

EXISTING WABC

PROPOSED WABC/SUNRISE

MATTER OF RIGHT CHURCH

SPRING

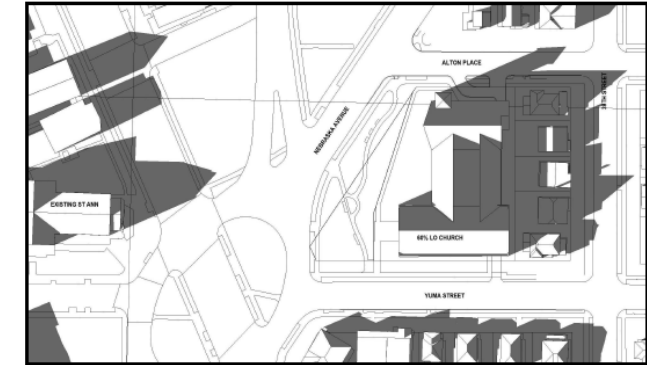
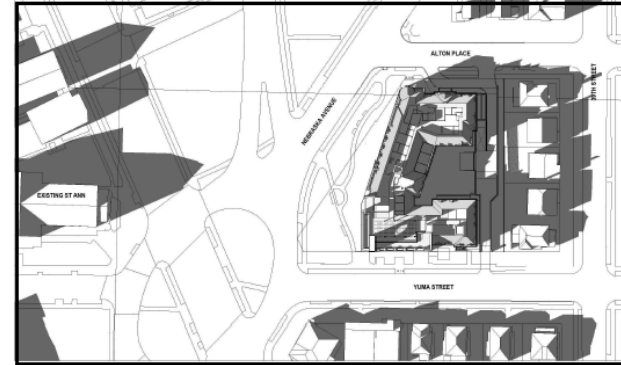
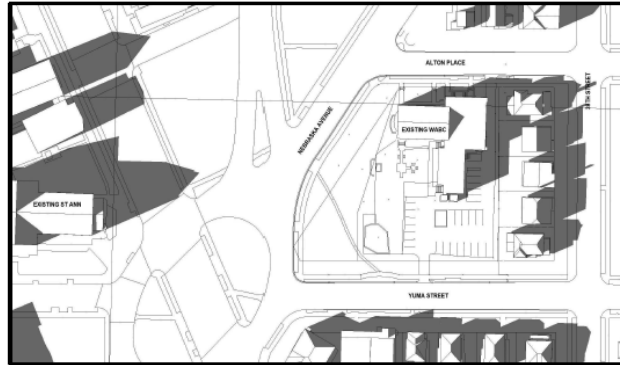

SUMMER

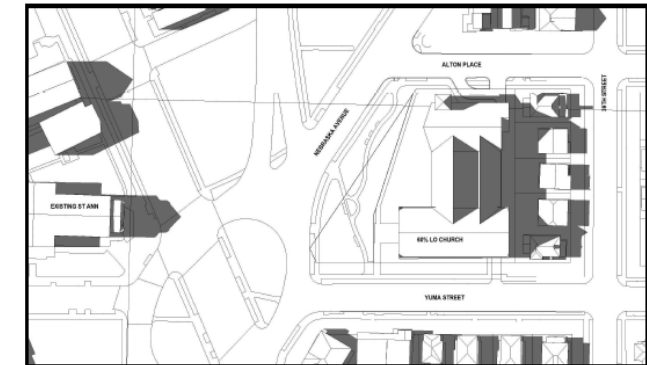
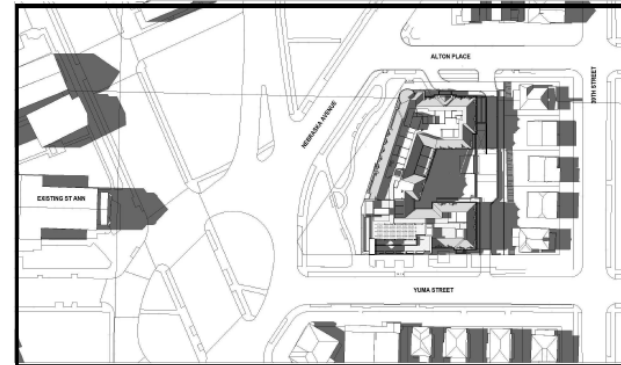
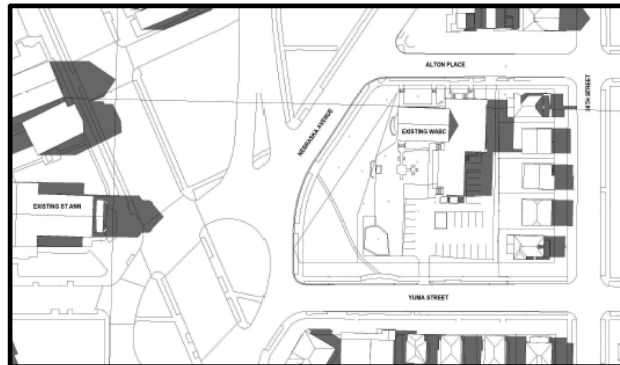

FALL

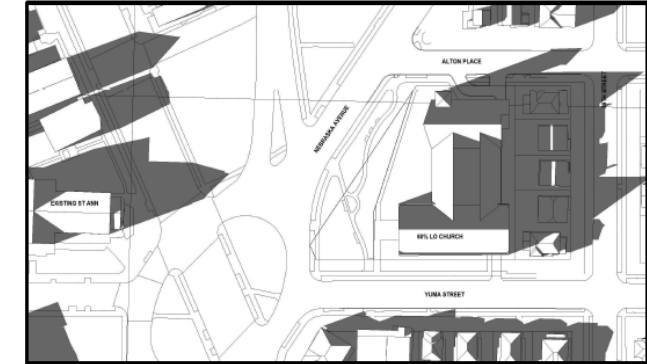
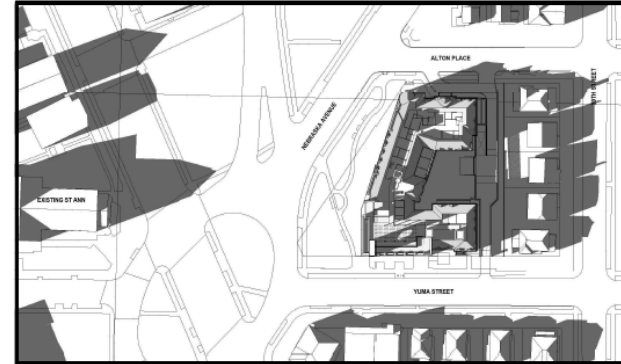
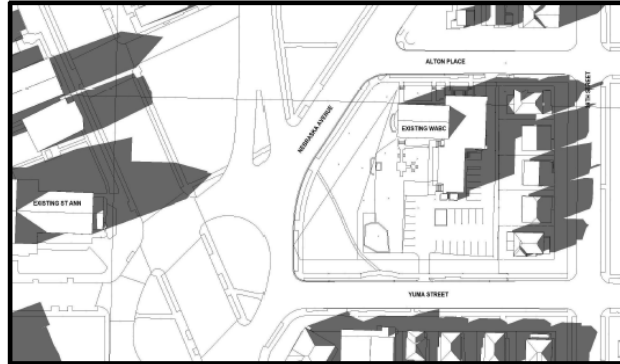

WINTER

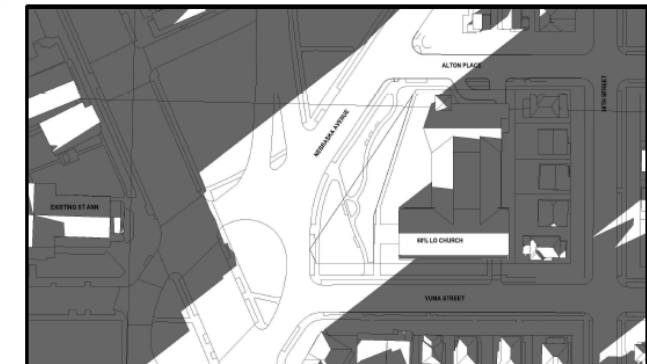
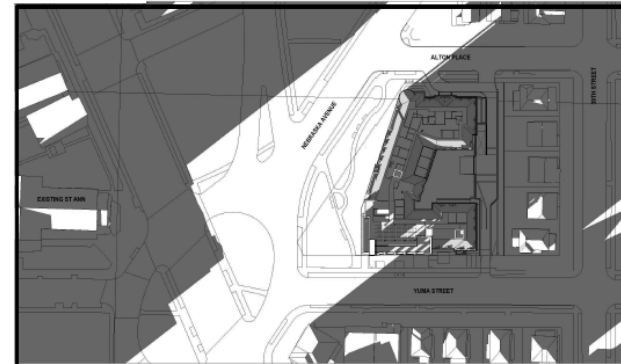
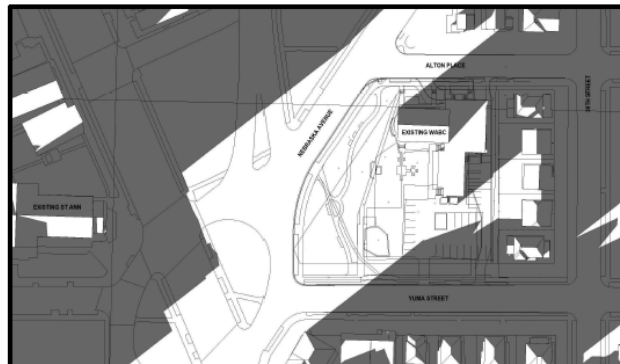

SHADOWS WILL INCREASE AT 4PM ONLY DURING THE SPRING AND FALL EQUINOX, AND THE WINTER SOLSTICE, WHEN TOTAL DARKNESS OCCURS APPROXIMATELY 50 MINUTES LATER

4PM